

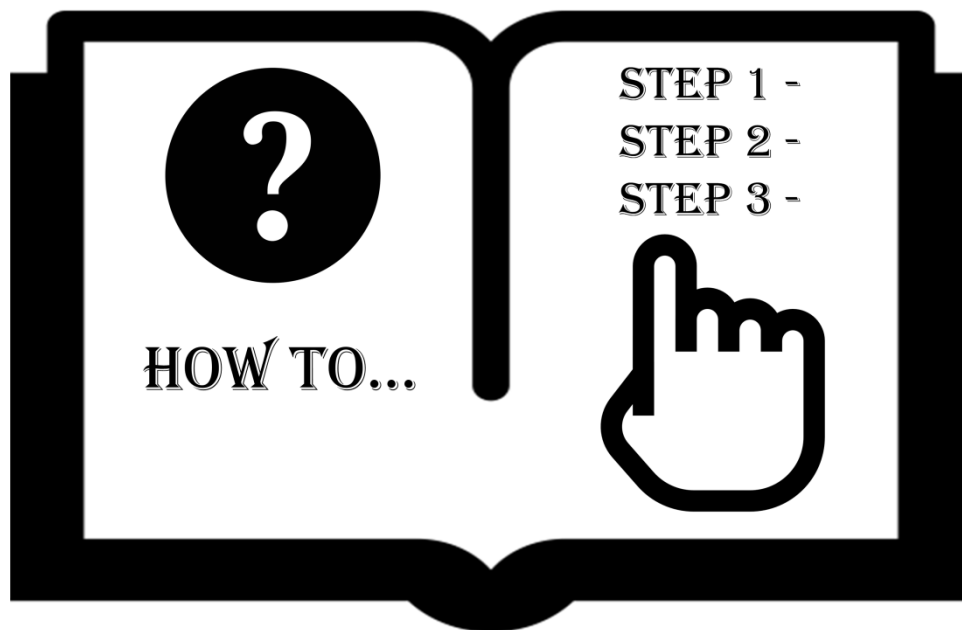

DVEO – How to Setup an RTMP Push Stream to YouTube

- A How-To Guide -

(Rev. 1.0 – July 10, 2018)



Computer Modules, Inc.
DVEO Division
11409 West Bernardo Court
San Diego, CA 92127, USA
Telephone: +1 858 613 1818
Fax: +1 858 613 1815
www.dveo.com

Copyright © 2018 Computer Modules, Inc. All Rights Reserved.
DVEO is a trademark of Computer Modules, Inc.
Specifications and product availability are subject to change without notice.

Streaming Live: YouTube

1. Launch your web browser and navigate to your YouTube Public URL Link (provided to you by YouTube)





2. Launch a second web browser window or tab and navigate to your DVEO server's web GUI interface URL. Go to the Stream Setup tab; select an available stream (left navigational pane); setup your Input (Eg. File setup). When finished with Input selection, select the Update button.

FILE: 1

Input Setup

✓ Data saved successfully!

ITEM	VALUE	UPDATE
Start Mode:	Manual ▾	
Execution Time (seconds):	<input type="text"/>	
File Description:	1 <input type="text"/>	
File Selection Mode:	Dropdown ▾	
Filename/Playlist:	Root Folder: Media Folder ▾ File Name: Nightsurfon.mp4 ▾	
Loop Playback:	<input checked="" type="checkbox"/>	
Input Buffer Size (ms):	300 <input type="text"/>	



- Go to New Output; from the Output Format dropdown menu, select the RTMP push with Flash (FLV) envelope (server to server) option, and then from the Demux Mode dropdown menu, select the Select All option. Type in your YouTube provided RTMP Public Stream Name and RTMP Target URI as shown here in this example. Click the checkbox for Enabled, and then select the Update button.

Enabled:	<input checked="" type="checkbox"/>
Output Name:	youtube
Output Format:	RTMP push with Flash (FLV) envelope (server to server) ▼
Demux Mode:	Select All ▼
RTMP Public Stream Name:	Type in your Youtube RTMP Public Stream Name/Key here
Primary RTMP Target URI:	Type in your Youtube RTMP Server URL here

Where can I find my YouTube account Server URL and Server name/key info?

Go to <https://www.youtube.com>

Log in with your user account

Navigate to 'My channel'

Select Video Manager

Select LIVE STREAMING

Scroll to bottom of page to Encoder Setup section

Server URL is displayed

Server name/key is masked, but can be viewed by selecting the Reveal button

- Select the Start button in the upper right hand Service Control pane.



5. Go to your web browser window or tab that is displaying your YouTube Public URL (from Step 1). After a few moments, the Live stream will display as shown here in this example.

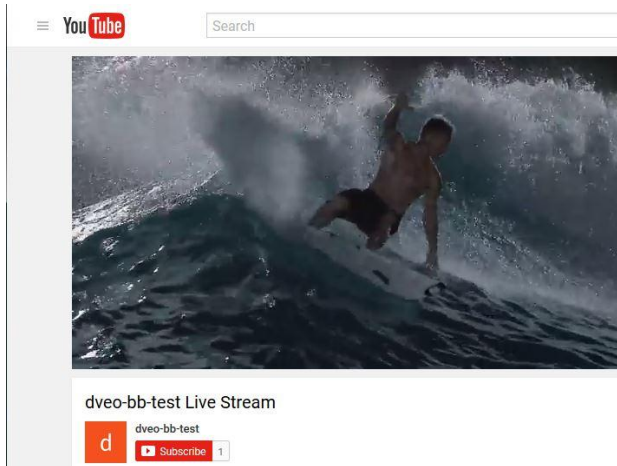

6. To end your live stream to YouTube, go back to your web browser window or tab displaying your DVEO server, navigate to the appropriate stream, and then select the Stop button in the Service Control panel in the upper right hand corner.



7. Then if you want to confirm, go back to your web browser window or tab displaying your YouTube Public URL and you will see the Live Stream Offline message as shown here.

