

Apollo I™ HDMI+Analog/QAM

Real Time Single Channel HDMI or Analog to QAM or DVB-C Modulator with MPEG-2 and H.264 Encoder with 1080i/p or 720p Support. One HDMI or YPbPr/CVBS Channel In, One QAM Channel Out, Plus USB Recording and Playback. Designed for Real Time MPEG-2/H.264 Encoding of Any HDCP Compliant HDMI Signal and Sending it Out Via Built In Frequency Agile QAM/DVB-C Modulator. Output Resolution is 1080i/p or 720p at 16x9. Designed to Present Information to Many Viewers from a Computer or Television! Ideal Product to Present Bus Station Schedules, Class Schedules, or Any Other Information That Originates in a Computer or HDMI Video Source. Supports MPEG-1 Layer II Audio in Via "Dual" Mini DIN Connector.



Features

- Accepts 1080p, 1080i, 720p, and 480i HDMI in
- Encodes HDMI to a high definition MPEG-2 or H.264 stream – 1080p (H.264 only) 1080i, or 720p
- Inputs (One channel at a time):
 - HDMI
 - YPbPr
 - CVBS
- Outputs:
 - Single QAM or DVB-C RF output
 - Records to .ts files on a Flash drive through USB port for playback later
- Can also create .ts files with previously recorded video, images, and audio, included TS Creator software
- Audio encoding: MPEG-1 Layer II, MPEG-2 AAC, MPEG 4 AAC, optional Dolby Digital® AC-3
- LCN (Logical Channel Number) support
- Excellent modulation quality MER≥42dB
- RF frequency range of 30~960 MHz
- Top-panel LCD and control buttons
- Easy to use menus, including inputs, encoding, channel, and RF options
- Compact size – 9.37 inches/238 millimeters long

Applications

- MDU venue monitoring
- Engineering labs
- In Store Demos of QAM receivers
- Digital signage on existing CCTV systems
- Test equipment for RF modulators
- Hotel and lodging video systems with spare channels

Overview

HDMI has quickly become one of the major standards for uncompressed video in the consumer world. Many input devices support HDMI, such as cameras and recorder/players – and many more are yet to come. QAM is the universal standard modulation for cable television content delivery. Often people want to share these outputs with many people via QAM tuner equipped televisions.

The Apollo I is an HDMI or analog to QAM or DVB-C modulator with MPEG-2 and MPEG-4 AVC/H.264 HD/SD encoding. It accepts one HDMI input or one analog (component or composite) input. The output is one QAM or DVB-C output.

The system also works as a USB recorder and player for digital signage, surveillance, etc. It encodes the source videos to .ts files and saves them to a USB flash drive. Users can also use the included “TS Creator” software to create .ts videos with previously recorded video, images, and audio.

The signal sources can be from satellite receivers, closed-circuit television cameras, Blue-ray players, antennas, etc. The output signals can be received by TVs, set-top boxes, etc. The system is operated via front panel controls or remote NMS web-based management.

You can now create an in-house cable system to play crystal clear HD over your coax cable.

The Apollo I is also an ideal product to present bus station schedules, class schedules, or any other information that originates in a computer. It is also useful in MDU digital insertion of security cameras for monitoring pools and parking facilities.

This is a great alternative to the more expensive brands.



Computer Modules, Inc.

11409 West Bernardo Court

San Diego, CA 92127

Tel: 858-613-1818 Fax: 858-613-1815

www.dveo.com

Inputs/Outputs

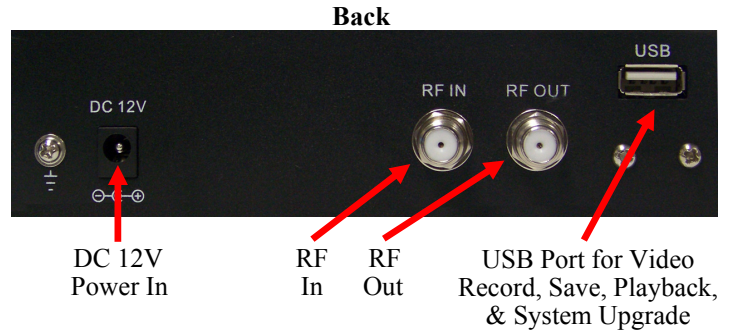
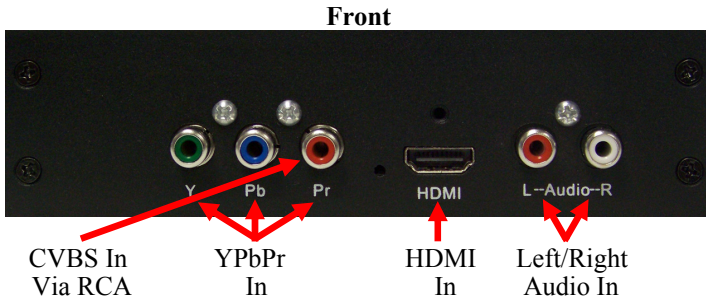

Specifications

HDMI Video Encoding

Input:	One HDMI input
Encoding:	MPEG-2, MPEG-4 AVC/H.264
Resolutions:	1920x1080 60p, 1920x1080 50p (for MPEG-4/H.264 only), 1920x1080 60i, 1920x1080 50i, 1280x720 60p, 1280x720 50p

HDMI Audio Encoding

Encoding:	MPEG-1 Layer II, MPEG-2 AAC, MPEG-4 AAC Optional Dolby Digital® AC-3
Interface:	HDMI
Sample Rate:	48 KHz
Bit Rates:	64 kbps, 96 kbps, 128 kbps, 192 kbps, 256 kbps, 320 kbps, 384 kbps

YPbPr/CVBS Video Encoding

Input:	One YPbPr input or one CVBS input
Encoding:	MPEG-2, MPEG-4 AVC/H.264
Resolutions:	YPbPr: 1920x1080 60i, 1920x1080 50i; 1280x720 60p, 1280x720 50p CVBS: 720x576 50i (PAL); 720x480 60i (NTSC)
Bit Rates:	0.500~19.500 Mbps

YPbPr/CVBS Audio Encoding

Encoding:	MPEG-1 Layer II, MPEG-2 AAC, MPEG-4 AAC Optional Dolby Digital® AC-3
Interface:	One Stereo/Two Mono
Sample Rate:	48 KHz
Bit Rates:	64 kbps, 96 kbps, 128 kbps, 192 kbps, 256 kbps, 320 kbps, 384 kbps

QAM/DVB-C Modulation

Standard:	J.83A (DVB-C)	J.83B	J.83C
Constellation:	16/32/64/128/256 QAM	64/256 QAM	64/256 QAM
Bandwidth:	J.83A – 8 MHz BW J.83B, J.83C – 6 MHz BW		
MER:	≥43dB		
RF Frequency:	30~960 MHz, 1 KHz step		
RF Output Level:	-16~ -36 dbm (71~91 dBμV), 0.1db step		
Symbol Rate:	5000-9000 Ksps		

System

Management:	Local control: LCD + control buttons
LCN Insertion:	Yes

#

Ordering Info

Apollo I HDMI+Analog/QAM

Other versions available:

HDMI to 8VSB, HDMI to DVB-T

Physical and Power

Dimensions:	5.64 x 9.37 x 2.05 inches (W x D x H) 144 x 238 x 52 mm (W x D x H)
Weight:	2 lbs. (0.97 kg)
Power Supply:	DC 12V
Operating Temperature:	0°C ~ +45°C (32°F ~ 113°F)
Conformities:	CE, RoHS

USB Recorder and Player

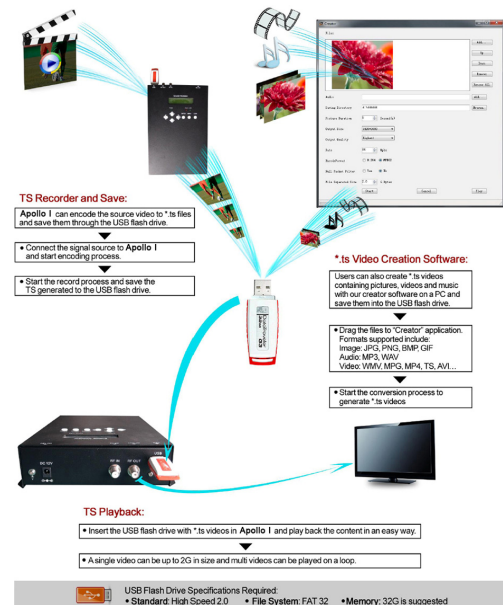

Application Example

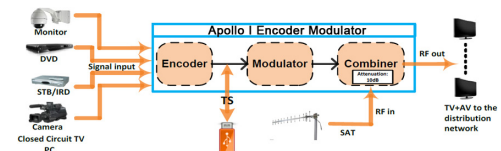

DVEO
Digital Video ExtraOrdinaire™

Computer Modules, Inc.
11409 West Bernardo Court
San Diego, CA 92127

Tel: 858-613-1818 Fax: 858-613-1815

www.dveo.com